

**1,500 SQFT LEASE SPACE
500 SQFT A/C OFFICE**

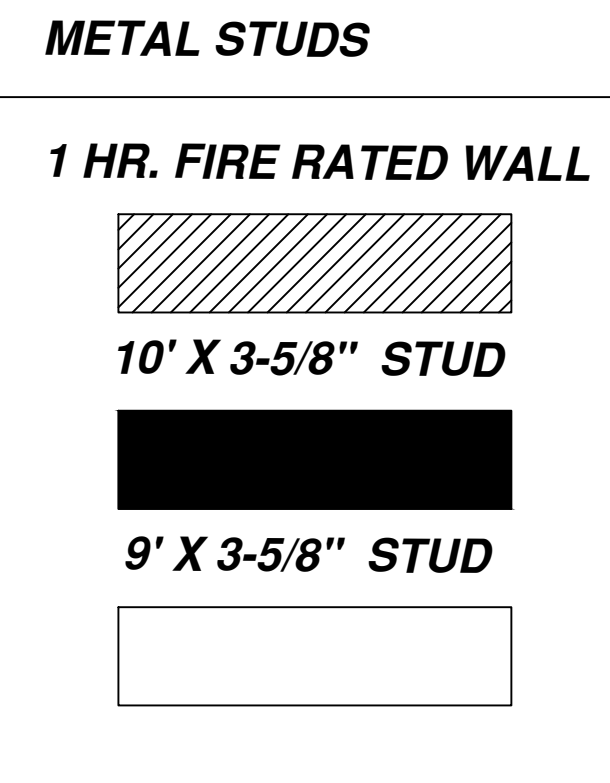

DETAILS

A/C OFFICE AREA:

- 9' CEILING HEIGHT
- 9' RACO SOLID DOORS
- LED LIGHTING
- KITCHENETTE
- HANDICAP BATHROOM
- HOT WATER HEATER

WAREHOUSE AREA:

- 16' EAVE & CLEAR HEIGHT
- WATER HOSE BIB
- PLUMBED FOR MOP SINK
- LED LIGHTING
- 120V OUTLETS ON ONE SIDEWALL

ELECTRICAL SERVICE:

- 200AMP 120/208 VOLT 3-PHASE WYE

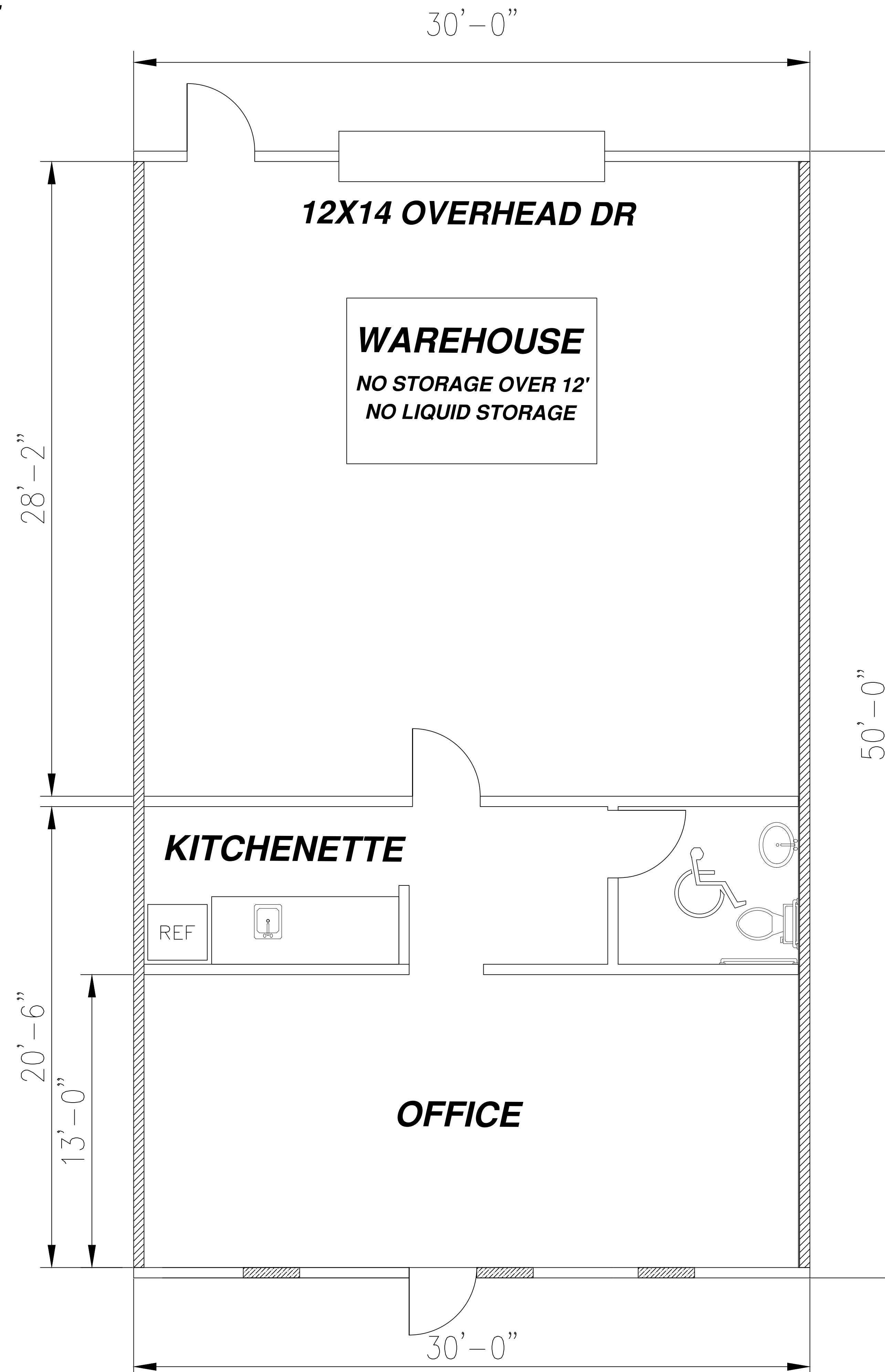

REVISION BLOCK	
BY:	10-10-24



OFFICE BUILDOUT
1500 SQ FT W/ 500 SQ FT OFFICE

ANGLETON 288 BUSINESS PARK
1850-1890 W. HENDERSON RD.
ANGLETON, TEXAS 77515