

**1,800 SQFT LEASE SPACE  
600 SQFT A/C OFFICE**

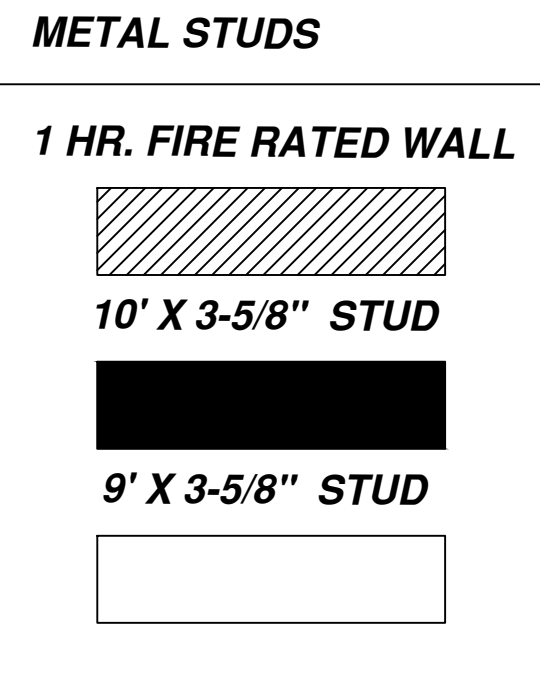

**DETAILS**

**A/C OFFICE AREA:**

- 9' CEILING HEIGHT
- 9' RACO SOLID DOORS
- LED LIGHTING
- KITCHENETTE
- HANDICAP BATHROOM
- HOT WATER HEATER

**WAREHOUSE AREA:**

- 16' EAVE & CLEAR HEIGHT
- WATER HOSE BIB
- PLUMBED FOR MOP SINK
- LED LIGHTING
- 120V OUTLETS ON ONE SIDEWALL

**ELECTRICAL SERVICE:**

- 200AMP 120/208 VOLT 3-PHASE WYE

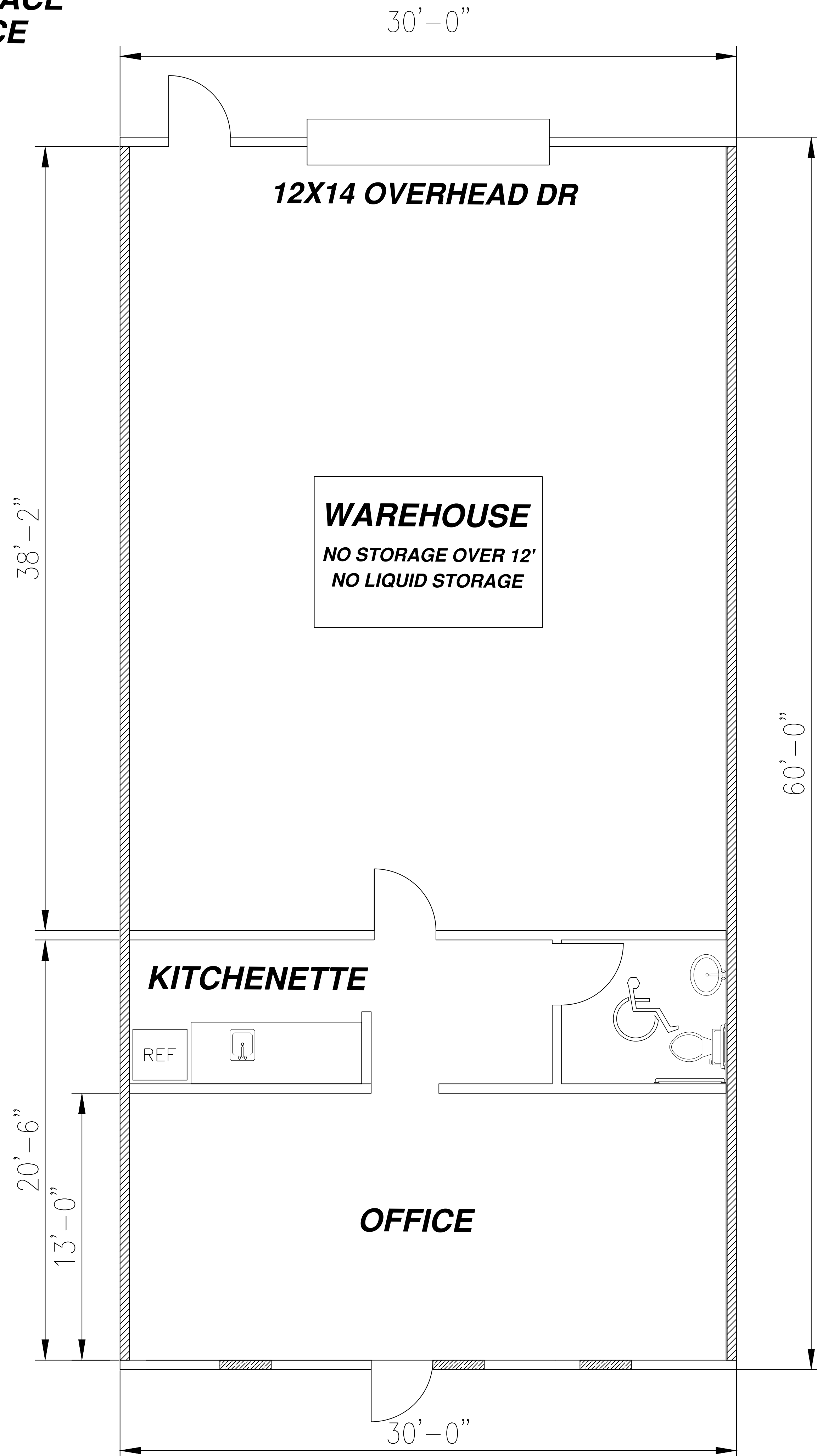

REVISION BLOCK	
BY:	10-10-24



**OFFICE BUILDOUT**  
1,800 SQ FT W/ 600 SQ FT OFFICE

ANGLETON 288 BUSINESS PARK  
1850-1890 W. HENDERSON RD.  
ANGLETON, TEXAS 77515